

Highland Cemetery

New Castle, CO

Est. 1888

Legend

-  MINERS
-  EARLY SETTLERS
-  MAYORS
-  **MARSHALL JOHN RENNIX**
1887-1910
Killed by William Griffith in a gunfight on Main Street.
-  **WILLIAM GRIFFITH**
1874-1910
Killed by self-inflicted gunshot wound after shoot out.
-  **ELLEN GANLEY**
1865-1968
First bride married in New Castle, midwife
-  **MERRIT VANDEVENTER**
1864-1919
First mayor and postmaster.
-  **KATHRYN SENOR**
1914-1993
Educator, namesake of Kathryn Senor Elementary School
-  **JOSEPHINE ROLLETO**
?-1956
Italian can-can dancer, grew flowers on Main Street.

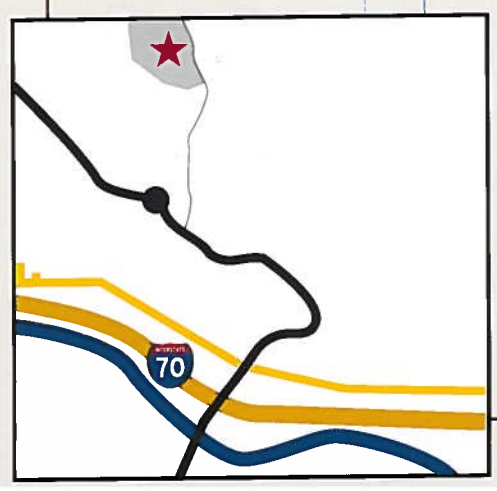
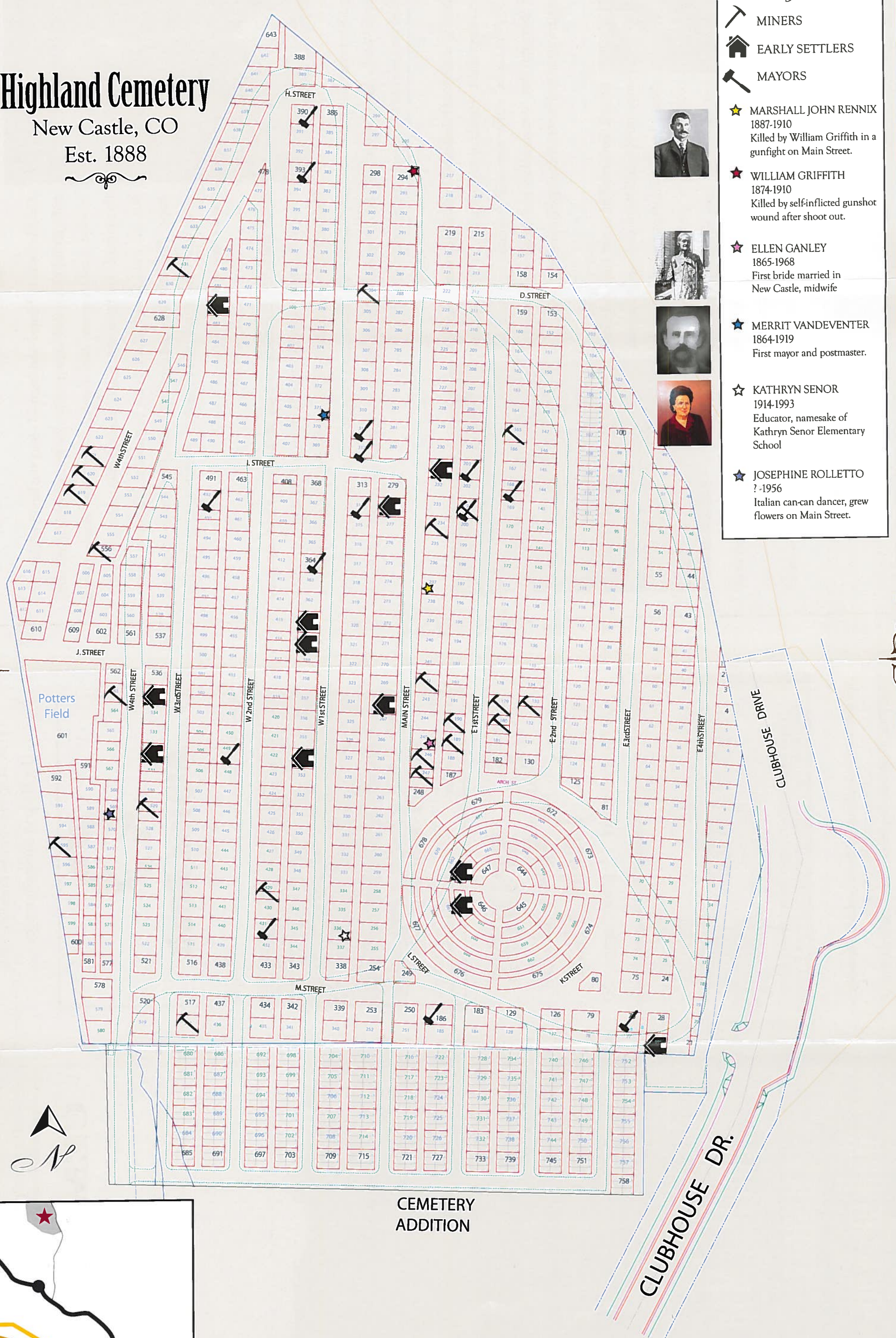

CEMETERY
ADDITION

CLUBHOUSE DR.



The Ute Indians hunted and camped along the banks of the Colorado (Grand) River and were possibly the first seasonal inhabitants of what would become New Castle. In 1775 the Escalante and Dominguez expedition also passed through this beautiful country. But not until Jasper Ward did a permanent community begin. Jasper, his wife Annie, and daughter Nettie, homesteaded 160 acres to the west of Elk Creek, and from then on, little by little our community took hold.

Jasper the farmer became Jasper the storekeeper, postmaster, and founder of present day New Castle. Unfortunately Jasper died just a few years later on August 25, 1887, attempting to be peacemaker in a dispute between the Ute Indian Chief "Colorow" and Jim Kendall, Garfield County Sheriff. At the time of Jasper Ward's death, New Castle did not have a dedicated cemetery, so Jasper was the first person buried in the Linwood Cemetery in Glenwood Springs.

Highland Cemetery was dedicated in 1888, the same year New Castle incorporated. Highland Cemetery has a very impressive "Old Soldiers Circle" where memorial programs are presented. Every Memorial Day, Veterans Day and Easter early morning services are presented in this stunning high country park.



Among those residing in our Highland Cemetery are Marshall Rennix who was killed in a shoot out on Main Street in 1910 by Billy Griffith. Ironically, they are buried only 75 feet apart. We have numerous Civil War

Veterans, Pioneers, and approximately 117 victims of the three early mine explosions and the people who stayed here in spite of the hardships. The people who stayed built banks, stores, lumber yards, brick yards, hotels, and newspapers. More importantly, they put down roots and raised their families, many of whom are still here in New Castle.



This Map was Made Possible with the Help of these Sponsors

Alpine Bank
www.alpinebank.com
Member FDIC

ELK CREEK
BAR & GRILL
MINING CO. EST. 1984

Steaks ★ Ribs ★ Burgers ★ Pasta ★ Brew
502 W. Main • New Castle, CO 81647
Mon. - Sat. 11:00 am-10:00 pm & Sunday 9:00 am-10:00 pm
(970) 984-0828 ElkCreekMining.com

SPIRITS
OF NEW CASTLE
LIQUOR STORE

302 WEST MAIN ST. NEW CASTLE, CO

Speckled Feather
MERCANTILE
303 W. Main Street
New Castle, Colorado 81647
970-573-6378 SpeckledFeather.com

Local Handcrafted Items • Gifts • Accessories
Colorado Foods • Papercrafting • Classes & More!

And the New Castle Historical Preservation Commission:
Chairman, Linda J. Holley
Jeff Ellis, Art Riddle, Virginia Erickson and Steve Rippey

HIGHLAND

CEMETERY

New Castle, Colorado



Cemetery Map

History

Walking Tour